



Speed and RPM Sensors

2.1.1 Blocking Oscillator Sensor

2.1.2 Inductive Sensor

2.1.3 Generator Sensor

2.1.4 Active Wheel Speed Sensor

2.1.1 Sensors and Switches | Speed and Revolution Sensors | **Blocking Oscillator Sensor**

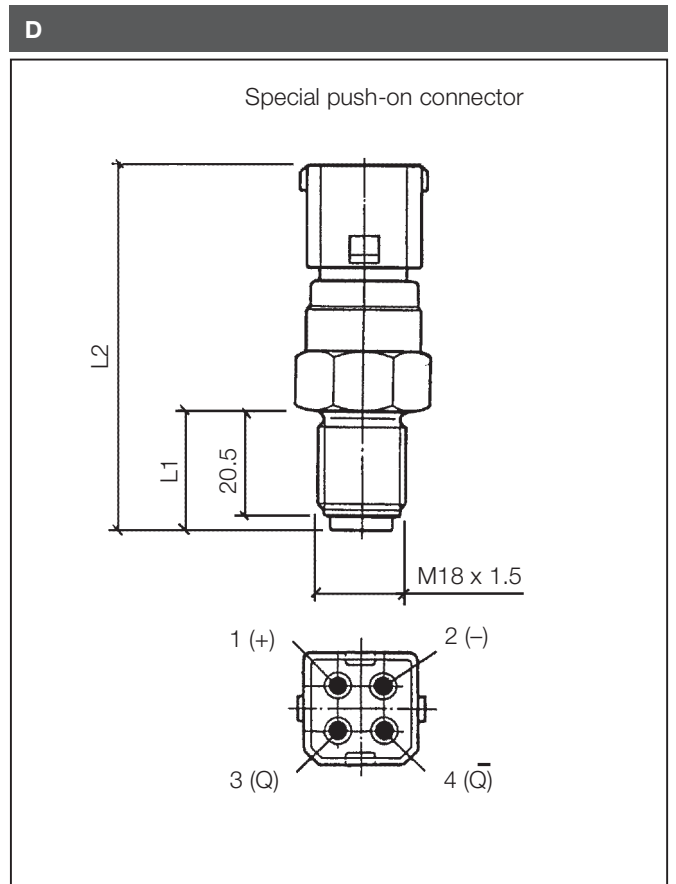
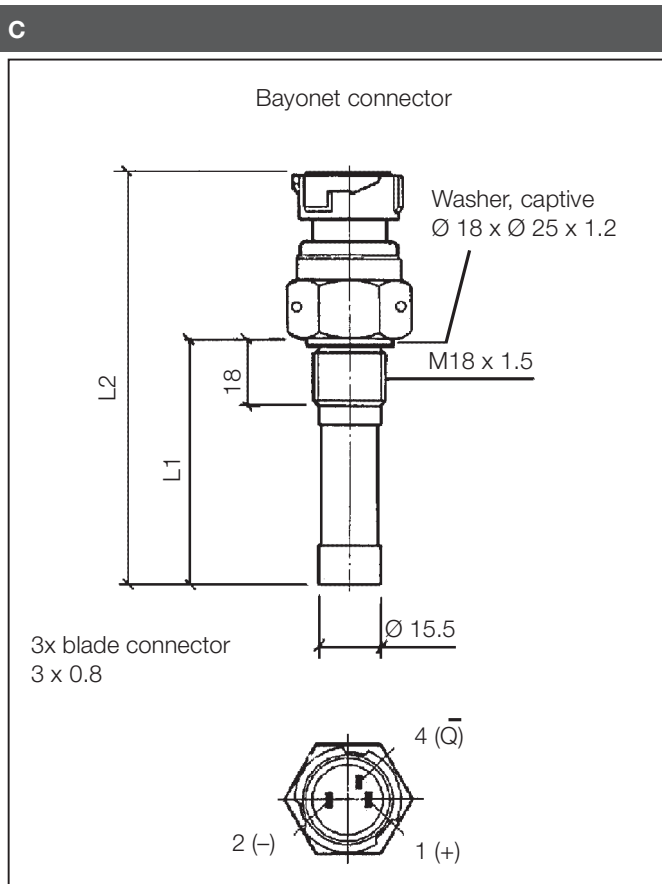
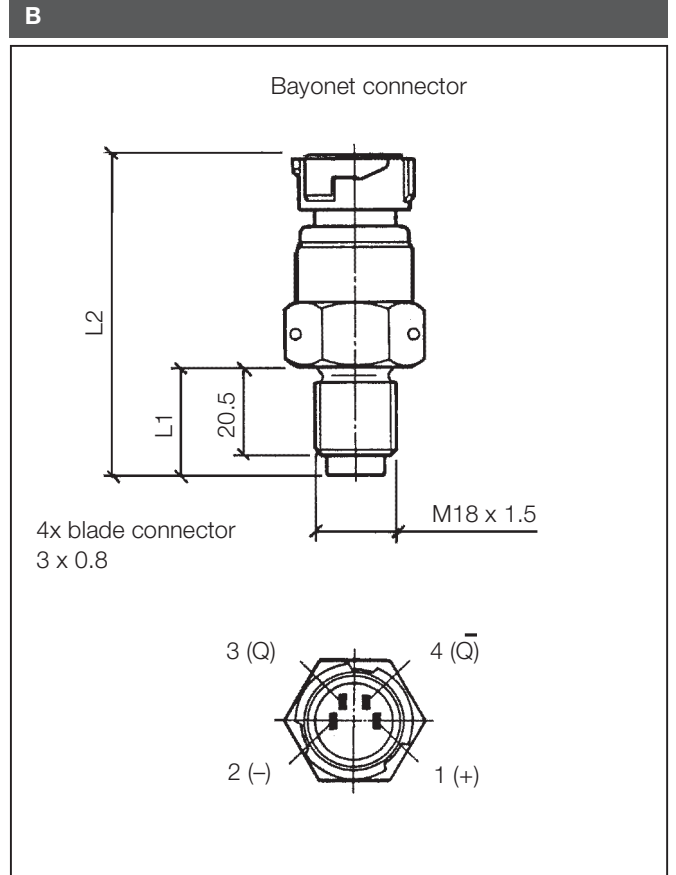
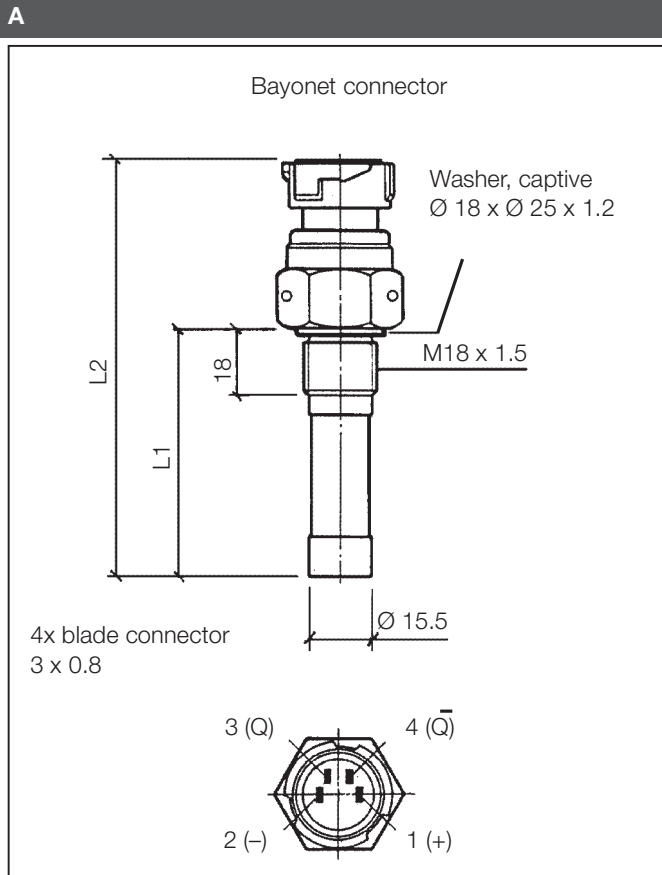

Part Number	Design	Length [mm]	
		L1	L2
340-216-010-003C	D	25	78.3
340-216-005-002C	A	63.2	106
A2C59513983	B	25	74
340-216-005-001C	A	90.2	133

Technical data	
Electrical connection	4-pole, insulated return
Sensor power supply	
Voltage	8–15 V
Current	12 mA
Operating temperature	-40 °C to +130 °C
Tooth repetition frequency	400 Hz
Distance sensor – pulse wheel	0.3 mm to 1.4 mm

Part Number	Design	Length [mm]	
		L1	L2
340-216-010-004C	C	90.2	133

Technical data	
Electrical connection	4-pole, insulated return
Sensor power supply	
Voltage	30 V
Current	14 mA
Operating temperature	-40 °C to +130 °C
Tooth repetition frequency	400 Hz
Distance sensor – pulse wheel	0.3 mm to 1.4 mm

2.1.2 Speed and Revolution Sensors | Inductive Sensor

A

Special push-on connector
(KOSTAL)

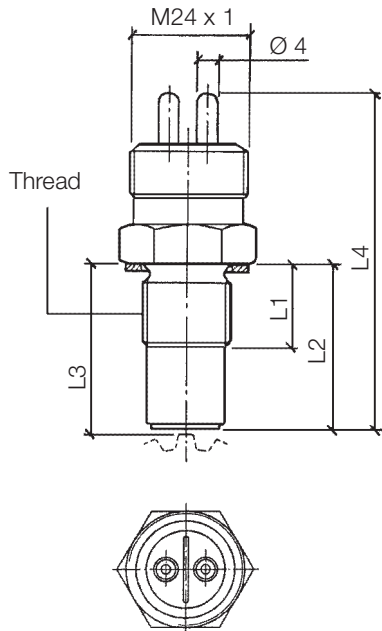

B

2x
blade connector
6.3 x 0.8 mm

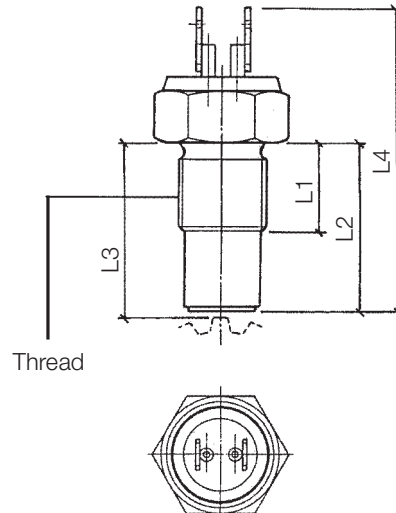

C

- C1** blade connector
G = 6.3 x 0.8 mm
W = 6.3 x 0.8 mm
- C2** blade connector
G = 4.8 x 0.8 mm
W = 6.3 x 0.8 mm

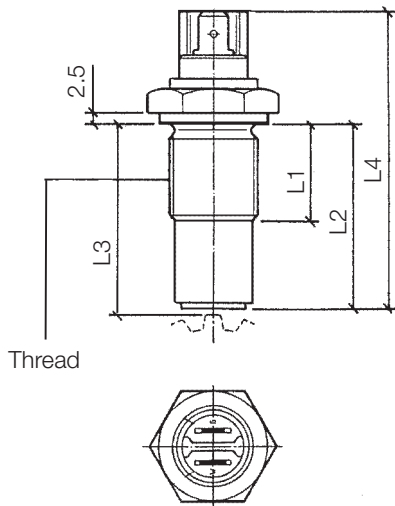

D

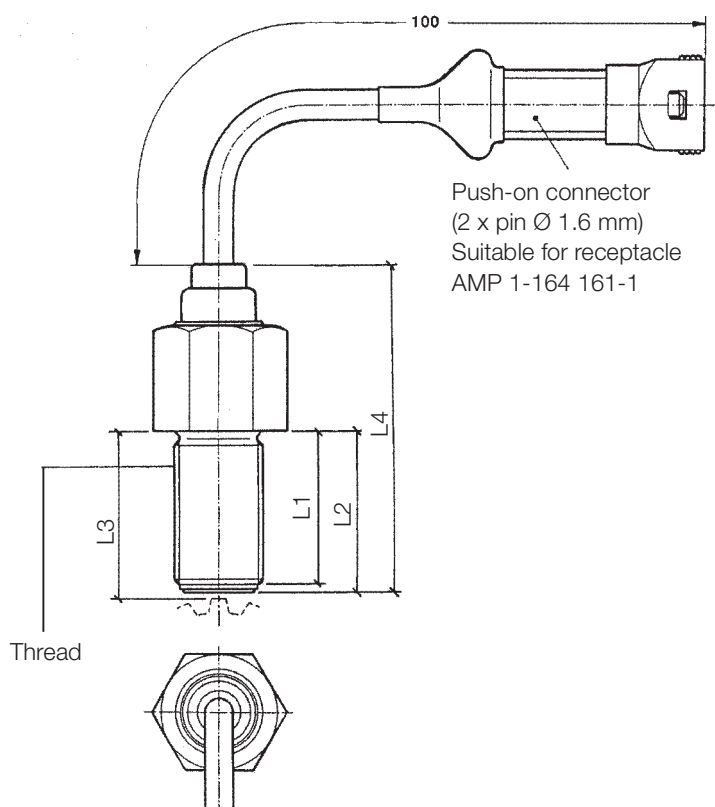

Push-on connector
(2 x pin Ø 1.6 mm)
Suitable for receptacle
AMP 1-164 161-1

Part Number	Thread	Length [mm]				Design	min. [°C]	RI [Ω]
		L1	L2	L3	L4			
340-804-005-007C	M18 x 1.5	15	35	36.1 ±0.1	71.5	A	-25	1,050
340-804-005-001C	M18 x 1.5	18	35	36.15–35.80	71.5	A	-30	1,050
340-804-005-012A*	M18 x 1.5 ¹	18	31.4	32.63–32.20	67.9	A	-30	1,050
340-804-005-013A	M18 x 1.5 ¹	18	71.4	72.63–72.20	107.9	A	-30	1,050
340-804-005-015C	M18 x 1.5	18	99.1	101.15–100.55	135.6	A	-30	1,050
340-804-005-016C*	M18 x 1.5 ¹	18	37.3	38.45–38.10	73.8	A	-30	1,050
340-804-005-018C	M18 x 1.5 ¹	18	45.7	46.95–46.45	82.2	A	-30	1,050
340-804-005-020C*	M18 x 1.5 ¹	18	37.3	38.45–38.1	73.8	A	-30	1,050
340-804-006-002C	M18 x 1.5	18	35	36.1 ±0.1	63.5	B	-30	1,050
340-804-007-019C	M18 x 1.5 ^{8,9}	18.2	70.7	71.8 ±0.1	79.7	C2	-25	1,050
340-804-030-006B	M18 x 1.5	18.2	70.7	71.8 ±0.1	93.5	D	-25	1,050
340-804-007-020C	M18 x 1.5 ^{8,9}	20	39	40.1 ±0.1	62	C2	-25	1,050
340-804-030-005B	M18 x 1.5	23.3	25	26.1 ±0.1	67	D	-25	1,050
340-804-005-002C	M18 x 1.5	24.9	26.5	27.65–27.30	63	A	-30	1,050
340-804-005-028C	M18 x 1.5	24.9	63.4	64.55–64.20	99.9	A	-30	1,050
340-804-005-033C	M18 x 1.5	24.9	26.5	27.5 ^{+0.15} _{-0.2}	63	A	-30	1,050
340-804-007-002A	M18 x 1.5	27.5	28.5	29.6 ±0.1	70	C1	-25	1,050
340-804-007-004C	3/4" - 16 UNF-2A ⁸	27.5	28.5	29.6 ±0.1	70	C1	-25	1,050
340-804-007-013C	M18 x 1.5 ⁸	27.5	28.5	29.6 ±0.1	70	C1	-25	1,050
340-804-006-007C	M18 x 1.5	33	34	35.1 ±0.1	62	B	-30	1,050
340-804-007-001C	M18 x 1.5 ⁹	33	34	35.1 ±0.1	70	C1	-25	1,050
340-804-007-003C	M18 x 1.5	33	34	35.1 ±0.1	64.5	B	-25	1,050
340-804-007-011C/G	M18 x 1.5	33	34	35.1 ±0.1	70	C1	-25	1,050

¹ With sealing washer, captive
⁸ With collar
⁹ With hexagonal nut M18 x 1.5
*Supplied on request – limited availability

Technical data	
Electrical connection	2-pole, insulated return
Voltage independent	
Operating temperature	-25 °C to +140 °C
Internal resistance, Ri	1,050 Ω ± 100 Ω
Test conditions	
Gear	36 teeth
Diametral pitch	2.75
Rotational speed	416.6 min ⁻¹
Frequency	250 Hz
Tooth width	7.5 mm
Load	47 kΩ
Gear centered	

2.1.3 Speed and Revolution Sensors | **Generator Sensor**

Dimensions [mm]

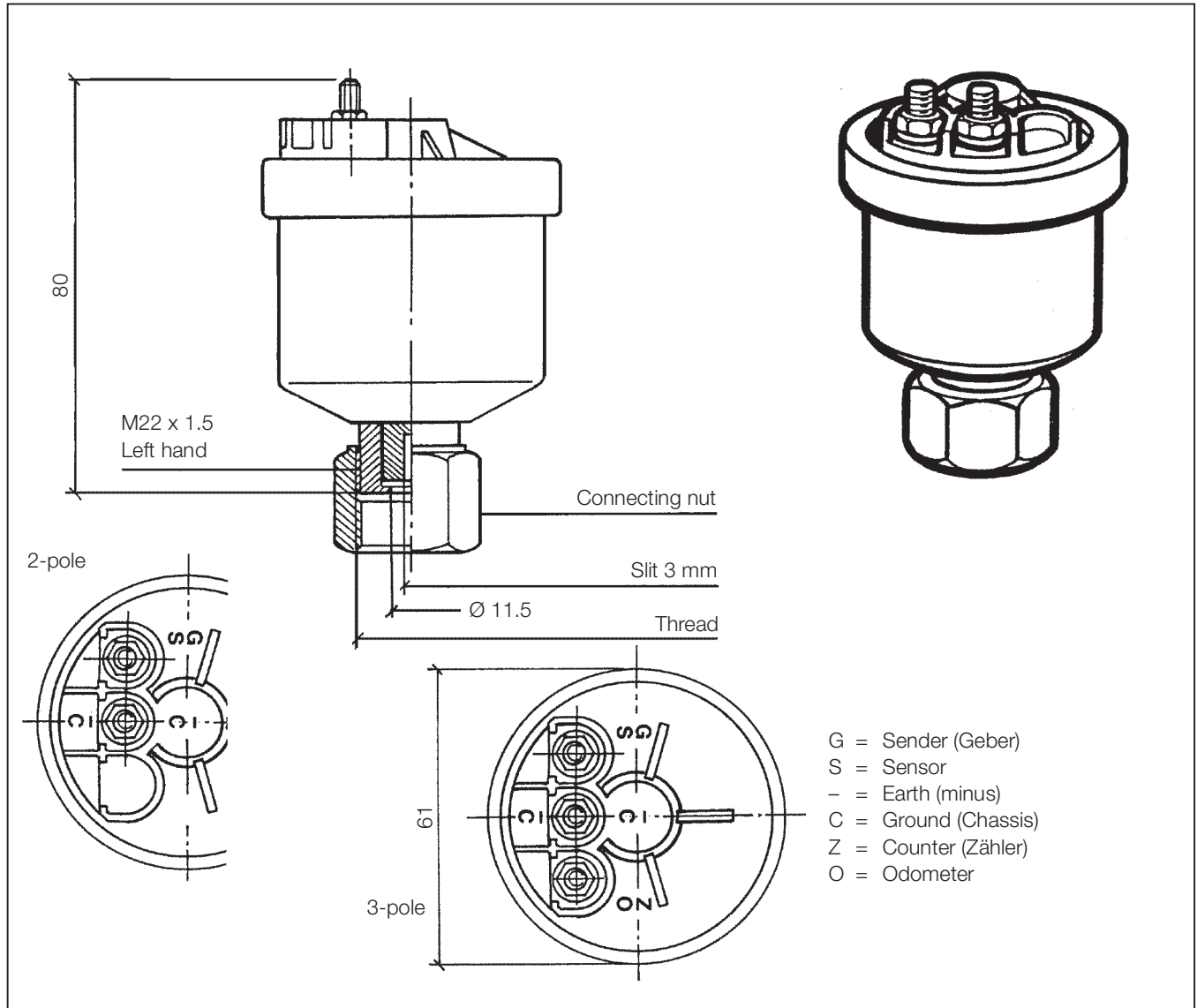

Type of connection

A1

2-pole, M4

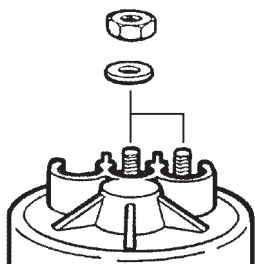

B1

3-pole, M4

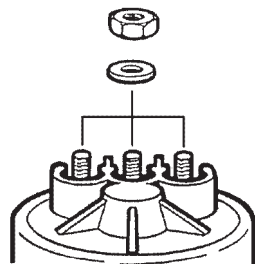

B2

3-pole, 8-32UNC-2A

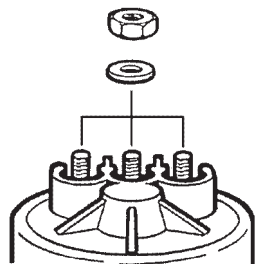

Part Number	Thread	Type of connection
340-808-001-002C/G	M22 x 1.5	A1
340-807-001-001C	M22 x 1.5	B1
340-808-001-004G	7/8" - 18NS-2A	A1
340-807-001-003C	7/8" - 18UNS-2B	B2

Technical data	
Electrical connection	2-pole, 3-pole, insulated return
Rotational speed	Max. 3,000 min ⁻¹
No-load voltage	19.3 V at 2,000 min ⁻¹
Operating temperature	-25 °C to +90 °C
Protection rating	IP54 as per DIN 40050

2.1.4 Speed and Revolution Sensors | Active Wheel Speed Sensor

Dimensions [mm]

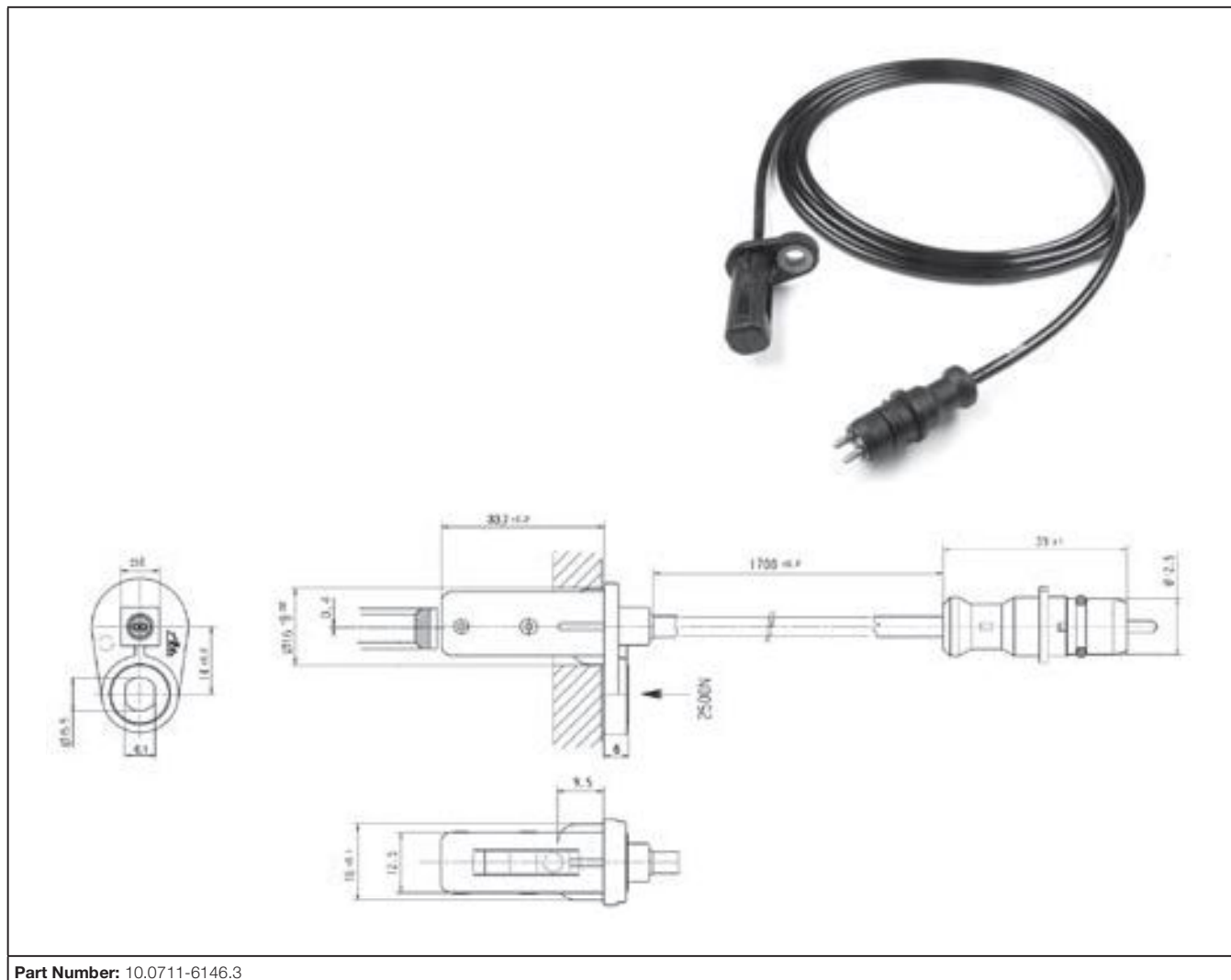

Part Number: 10.0711-6146.3

Technical data	
Voltage	-40 °C to +60 °C: 7,5 V–20 V +60 °C to +150 °C: 7,5 V–16 V
Operating temperature	Sensor body: -40 °C to +150 °C Cable/Plug: -40 °C to +115 °C
Plug Swoboda	IP 67 according to DIN 40050 part 9
Current	I_{low} : 7 mA (+20 % / -16 %) I_{high} : 14 mA (+20 % / -16 %)
Cable length	1.700 mm (Other lengths available on request)

Description
<p>This active sensor, derived from the large series production, features high reliability and robustness. Due to its large air tolerance it can be fitted to the vehicle with little effort.</p> <ul style="list-style-type: none"> • Pulse generator in form of a pole wheel • Suitable cable harness interface in form of a so-called „Swoboda“ plug • Fastened as shown